

Accessing ConnSCU Wireless from Android

(Revision Date: 7/28/2016)

Introduction

This is an encrypted network for students, faculty and staff. It is the recommended wireless network for anyone with a ConnSCU NetID.

You will need a wireless device which supports WPA2 in order to connect to this network, and you will have to configure a wireless connection (see details below for platform specific information) before you can connect. Once configured, most clients will be able to reconnect automatically rather than having to re-enter your credentials.

Connecting to the ConnSCU Internet Wireless Network

Step 1 – Access ‘Wi-Fi Settings’ from your Android.

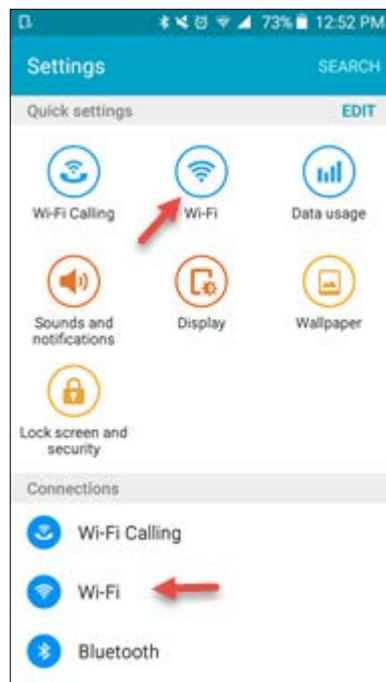

Step 2 – From the list of available wireless networks, select ‘ConnSCU’ and ensure the wireless slider is ‘ON’.



Step 3 - You will be prompted to enter your login credentials. Insert your NetID under ‘Identity’ and ‘Anonymous Identity’, password, then click ‘Connect’:

- Community College and BOR System Office users should sign in with the [NetID](#). E.g:
Identity& Anonymous Identity: 01234567@commnet.edu
Password: Existing password

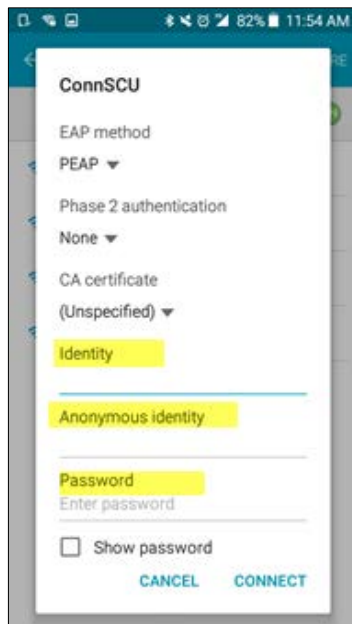

Step 4 – If prompted, click ‘Yes’ to accept the server certificate and complete your Wireless connection.

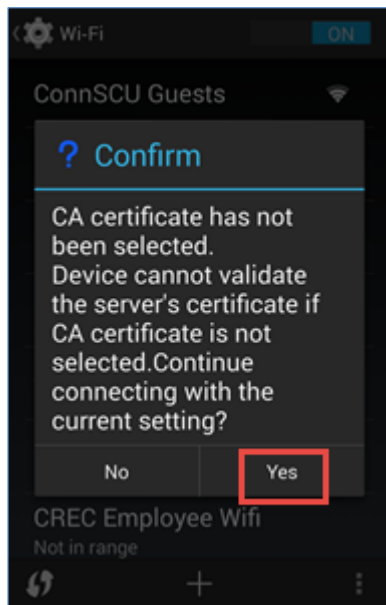

Finished!

Contacting Support

If you have any issues or questions, please contact your [local IT department](#).

[Support Services](#)